

NC cyclone

Basic cyclone to separate large materials from the airflow

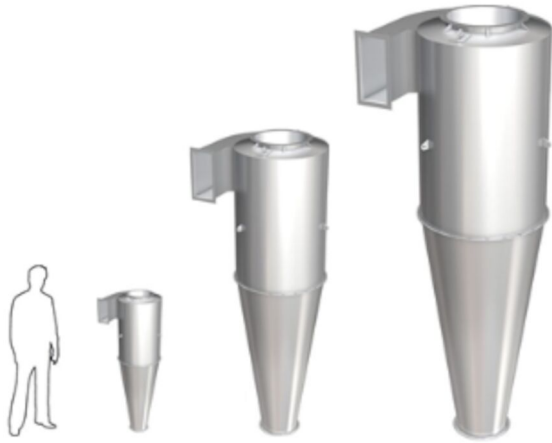

The cyclone is a separator that uses centrifugal force to purify air loaded with chips or dust. Its performance depends on the rotation speed, density and grading of particles. Cyclones are available with a wide range of accessories.







- Efficiency approx. 90% for particles above 10 micron.
- Higher efficiency for large particles.
- Built in 2 and 3 mm (.08 in and .1 in)-thick steel sheet depending on the size.
- Max temperature 75°C (167°F) with standard paint.

| | |
|--------------|---|
| Product name | NC cyclone |
| Installation | Outdoor |
| Material | 2 and 3 mm (.08 in and .1 in)-thick steel sheet |

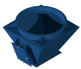
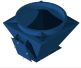
NC cyclone

| Description | Weight (kg) | Model |
|-----------------|-------------|----------|
| | 53 | 73003852 |
| | 53 | 73003846 |
| | 123 | 73003854 |
| | 123 | 73003847 |
| | 306 | 73003855 |
| | 306 | 73003848 |
| | 433 | 73003856 |
| | 433 | 73003849 |
| | 550 | 73003857 |
| | 550 | 73003850 |
| | 804 | 73003858 |
| | 804 | 73003851 |
| | 1278 | 73006417 |
| | 1278 | 73006415 |
| Cyclone NHC 315 | 15 | NHC315 |
| | 50 | NHC630 |

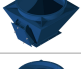
NC cyclone

| | Accessory | Part No |
|---|--|----------|
| | Tangential outlet right for NC 500 left cyclone | 73006362 |
| | Tangential outlet left for NC 500 right cyclone | 73003859 |
| | Tangential outlet right for NC 700 left cyclone | 73003870 |
| | Tangential outlet left for NC 700 right cyclone | 73003861 |
| | Tangential outlet right for NC 1000 left cyclone | 73003872 |
| | Tangential outlet left for NC 1000 right cyclone | 73003863 |
| | Tangential outlet right for NC 1150 left cyclone | 73003874 |
| | Tangential outlet left for NC 1150 right cyclone | 73003865 |
| | Tangential outlet right for NC 1300 left cyclone | 7906144 |
| | Tangential outlet left for NC 1300 right cyclone | 73003867 |
| | Tangential outlet right for NC 1600 left cyclone | 73003876 |
| | Tangential outlet left for NC 1600 right cyclone | 7989871 |
|  | Transition to NRS(Z) 4 for NC 700 cyclone | 73003878 |
|  | Transition to NRS(Z) 4 for NC 1000 cyclone | 73003879 |
|  | Transition to NRS(Z) 4 for NC 1150 cyclone | 73003880 |
|  | Transition to NRS(Z) 4 for NC 1300 cyclone | 73006363 |
|  | Transition to NRS(Z) 4 for NC 1600 cyclone | 73003881 |
|  | Transition to NRS(Z) 4 for NC 2000 cyclone | 73006438 |
|  | Transition to NRS(Z) 4 for NC 2500 cyclone | 73006439 |
|  | Transition to NRS(Z) 4 for NC 500 cyclone | 73003877 |
| | Transition to NRS(Z) 10 for NC 700 cyclone | 73003882 |
| | Transition to NRS(Z) 10 for NC 1000 cyclone | 73003883 |

NC cyclone

| | Accessory | Part No |
|---|---|-----------|
| | Transition to NRS(Z) 10 for NC 1150 cyclone | 73003884 |
| | Transition to NRS(Z) 10 for NC 1300 cyclone | 73003885 |
| | Transition to NRS(Z) 10 for NC 1600 cyclone | 73006364 |
| | Transition to NRS(Z) 10 for NC 2500 cyclone | 73003886 |
|  | Bin for dust for cyclone NC500 | 73007861 |
|  | Bin for dust for cyclone NC700 | 73007862 |
|  | Bin for dust for cyclone NC1150 | 73007864 |
|  | Bin for dust for cyclone NC1300 | 73007865 |
|  | Bin for dust for cyclone NC1600 | 73007866 |
|  | Ex tangential outlet left for NC 1150 right cyclone | 73003866* |
| | Ex tangential outlet right for NC 1300 left cyclone | 73006431* |
| | Cyclone NC 500 galvanized inlet, QF 200 | 73006355 |
| | Cyclone NC 700 galvanized inlet, QF 250 | 73003319 |
| | Cyclone NC 700 galvanized inlet, QF 315 | 73003320 |
| | Cyclone NC 700 galvanized inlet, QF 350 | 73003321 |
| | Cyclone NC 1000 galvanized inlet, QF 350 | 7988029 |
| | Cyclone NC 1150 galvanized inlet, QF 350 | 73003323 |
| | Cyclone NC 1150 galvanized inlet, QF 400 | 73006378 |
| | Cyclone NC 1300 galvanized inlet, QF 400 | 73003324 |
| | Cyclone NC 1300 galvanized inlet QF 500 | 73006469 |
| | Cyclone NC 1600 galvanized inlet QF 560 | 73006472 |
| | Cyclone NC 1600 galvanized inlet QF 630 | 73006474 |

NC cyclone

| Accessory | Part No |
|--|----------|
| Cyclone NC 500 galvanized inlet FL 250 | 73006488 |
| Cyclone NC 700 galvanized inlet, FL 250 | 73003589 |
| Cyclone NC 1000 galvanized inlet, FL 400 | 73001191 |
| Cyclone NC 1150 galvanized inlet, FL 400 | 7983444 |
| Cyclone NC 1300 galvanized inlet, FL 450 | 7980966 |
| Cyclone NC 1300 galvanized inlet FL 500 | 73006496 |
| Cyclone NC 500 2mm welded inlet FL 200 | 73006538 |
| Cyclone NC 500 2mm welded inlet FL 224 | 73006539 |
| Cyclone NC 500 2mm welded inlet FL 250 | 73006540 |
| Cyclone NC 1300 2mm welded inlet FL 400 | 73006547 |
| Cyclone NC 1300 2mm welded inlet FL 450 | 73006548 |
| Cyclone NC 1300 2mm welded inlet FL 500 | 73006549 |
| Cyclone NC 1600 2mm welded inlet FL 450 | 73006550 |
| Cyclone NC 1600 2mm welded inlet FL 500 | 73006551 |
| Cyclone NC 1600 2mm welded inlet FL 550 | 73006552 |
| Cyclone NC 1600 2mm welded inlet, FL 560 | 73005433 |
| Cyclone NC 2000 2mm welded inlet FL 800 | 73006560 |
| Cyclone NC 2500 2mm welded inlet FL 800 | 73006561 |
| Cyclone NC 2500 2mm welded inlet, FL 900 | 73003688 |

**Explosion panels on Ex Tangential outlet was calculated based on dust value listed in Dust table. For cyclones in an installation working with explosion dust, the customer should make additional calculation for the vent area. Relief area in the Ex tangential outlet can be too small for conditions and all installation.*

NC cyclone

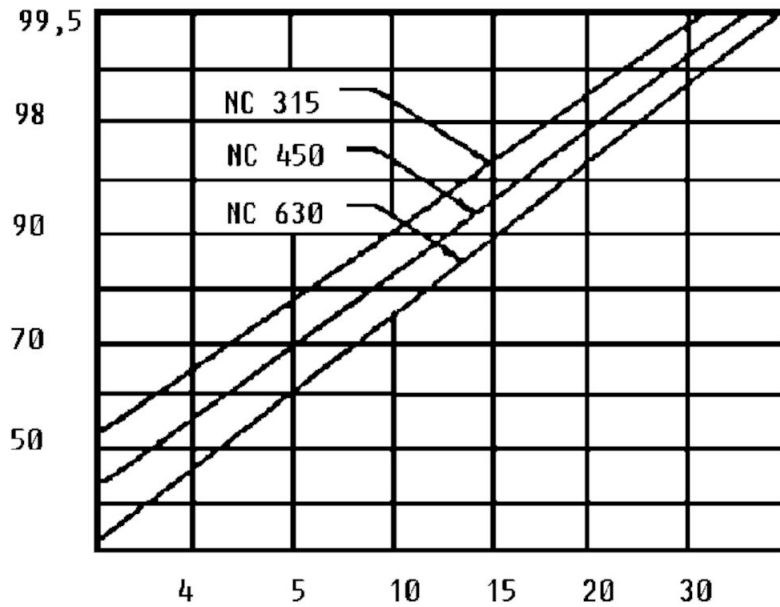

Efficiency NHC 315-630

X= %
Y= µm

| Dust value | | | | |
|------------|-------------|-----------------|-------------|--------------|
| | K_v [bar] | P_{max} [bar] | Volume [m³] | Parties Qty. |
| NC 500 | 150 | 6 | 0,24 | 1 |
| NC 700 | 170 | 6 | 0,68 | 1 |
| NC 1000 | 100 | 6 | 2,01 | 1 |
| NC 1150 | 130 | 6 | 3,15 | 1 |
| NC 1300 | 125 | 6 | 4,49 | 1 |
| NC 1600 | 115 | 6 | 7,74 | 1 |
| NC 2000 | 160 | 6 | 13,99 | 2 |
| NC 2500 | 170 | 6 | 24,12 | 3 |

NC cyclone

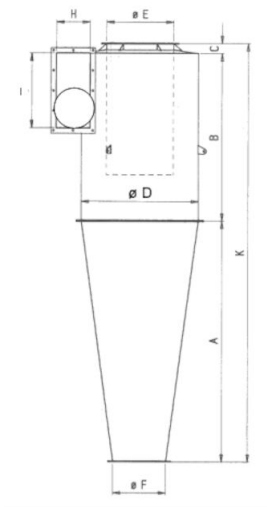
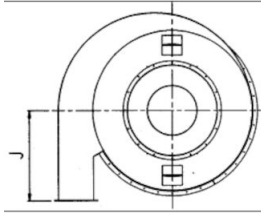

Dimensions

| Type | A | B | C | Ø D | Ø E | Ø F | H | I | J | K | Weight |
|---------|------|------|------|------|------|------|------|------|------|------|--------|
| | [mm] | [mm] | [mm] | [mm] | [mm] | [mm] | [mm] | [mm] | [mm] | [mm] | [kg] |
| NC 500 | 1000 | 700 | 80 | 500 | 250 | 200 | 126 | 285 | 305 | 1780 | 53 |
| NC 700 | 1430 | 990 | 60 | 700 | 400 | 315 | 206 | 444 | 501 | 2480 | 123 |
| NC 1000 | 2048 | 1500 | 100 | 1000 | 560 | 400 | 216 | 485 | 606 | 3648 | 306 |
| NC 1150 | 2395 | 1800 | 100 | 1150 | 630 | 450 | 240 | 550 | 675 | 4300 | 433 |
| NC 1300 | 2825 | 2000 | 120 | 1300 | 710 | 450 | 300 | 600 | 700 | 4945 | 550 |
| NC 1600 | 3300 | 2300 | 100 | 1600 | 900 | 500 | 357 | 905 | 600 | 5700 | 804 |
| NC 2000 | 3930 | 2600 | 170 | 2000 | 1200 | 630 | 401 | 1247 | 1200 | 6700 | 1278 |
| NC 2500 | 4205 | 3000 | 170 | 2500 | 1600 | 710 | 507 | 1364 | 1200 | 7375 | 1647 |

Dimensions Cyclone type 500-2500

NC cyclone

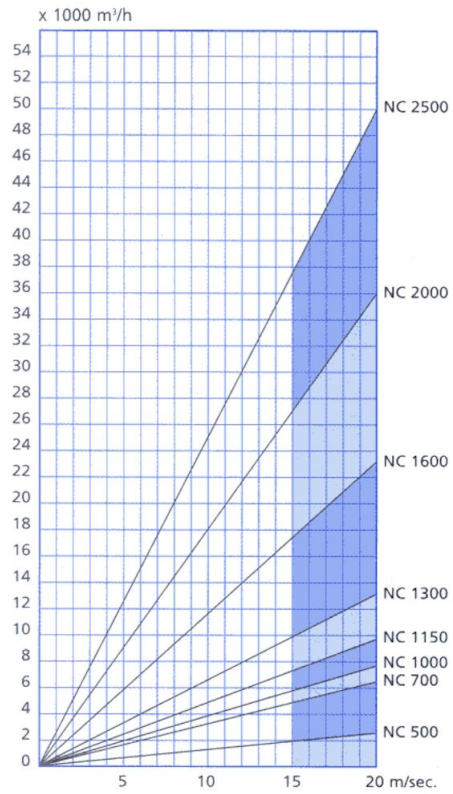
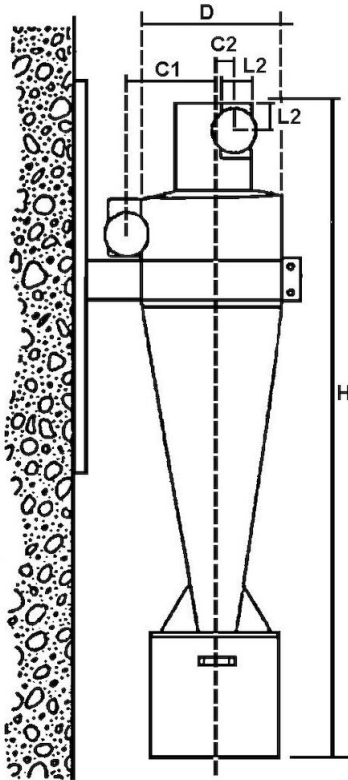

Diagram NC 500-2500

NC cyclone



| Type | C1 | L1 | C2 | L2 |
|------|-----|-----|-----|-----|
| 315 | 189 | 252 | 58 | 63 |
| 450 | 270 | 360 | 80 | 90 |
| 630 | 378 | 500 | 115 | 125 |

NC cyclone

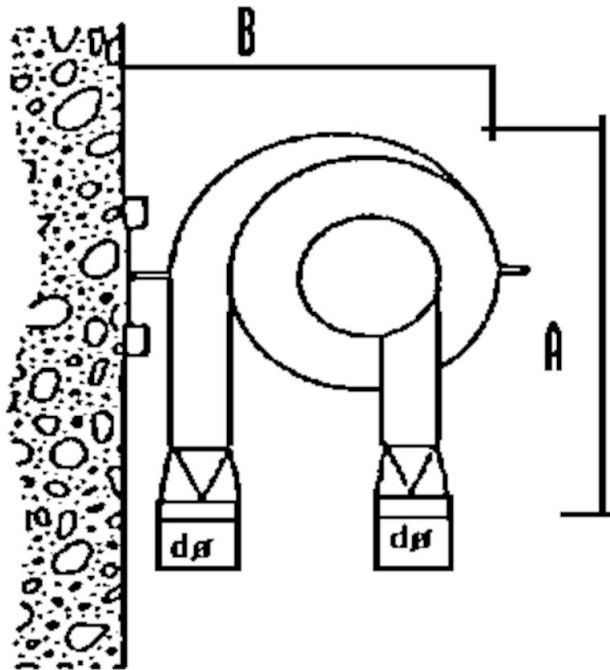

| Type | D (mm) | A (mm) | B (mm) | H (mm) | d (mm) | Vægt (kg) | Art. no. Cyclone right | Art. no. Cyclone left | Art. no. Wall support |
|---------|--------|--------|--------|--------|--------|-----------|------------------------|-----------------------|-----------------------|
| NHC 315 | 315 | 500 | 500 | 1550 | 100 | 15 | 47100.315 | 47101.315 | 47190.315 |
| NHC 450 | 450 | 600 | 650 | 2100 | 125 | 20 | 47100.450 | 47101.450 | 47190.450 |
| NHC 630 | 630 | 700 | 750 | 2700 | 160 | 50 | 47100.630 | 47101.630 | 47190.630 |

All dimensions in mm

NC cyclone

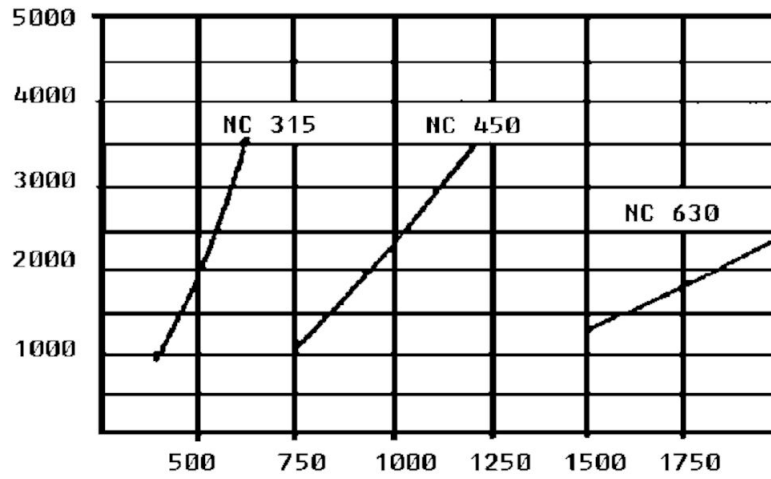

Pressure drop diagram for NHC315-630

X = Pa
Y = m³/h