

## BenchTop Extraction Arm FX2 100 ESD/EX

The best and most cost-efficient solution for extraction of hazardous airborne contaminants, in applications where small, flexible and easy-to-use arms are required.



Nederman FX2 arms are made of lightweight anodized aluminium sections, with two or three adjustable, composite friction joints. Offering strength and durability combined with easy handling, they can be used in many types of environment. They are especially suitable for applications where small, flexible and easy-to-use arms are required.

The arm is designed for use in electronic environments where there is a risk of electrostatic discharges. The ESD/EX can also be used for certain applications in potentially explosive atmospheres.







Recommended for use in zone 1, 2 and 21, 22.

- Optimal efficiency and low noise provides safe and quiet working environment
- Ceilings, walls and floors or fixed to worktops mountings and cut2fit extension profile gives maximum installation flexibility
- The two outermost arm joints can rotate and swivel through 360°, which gives the unique maneuverability
- The lean, smooth and aesthetic design allows arms to fit in well in any environment without compromising its durability and reliability
- Highly integrated products that save customers' time and costs, as well as providing the reliability and functionality to deliver a better performance

|                              |  |
|------------------------------|--|
| Product name                 | BenchTop Extraction Arm FX2 100 ESD/EX   |
| Noise level (dB(A))          | 62 dB(A) at 450 m <sup>3</sup> /h  |
| Installation                 | [Indoor]   |
| Material                     | Tubes in anodized aluminium. Joints in conductive PP plastic. Duct connector in conductive EPDM rubber. Minihood in conductive PP plastic. |
| Fume temperature             | max 70°C   |
| Extraction arm diameter (mm) | 100  |
| Airflow (m <sup>3</sup> /h)  | 200 - 450  |



## BenchTop Extraction Arm FX2 100 ESD/EX

| Image  | Description                        | Arm length (m) | Colour             | Weight (kg) | Model        |
|--|------------------------------------|----------------|--------------------|-------------|--------------|
|   | FX2-ESD/EX-D100-L1200-Up/Down-Low  | 1,2            | Aluminum and black | 4,8         | 70606544*    |
|   | FX2-ESD/EX-D100-L1200-Up/Down-Thru | 1,2            | Aluminum and black | 4,1         | 70606744*    |
|   | FX2-ESD/EX-D100-L1800-Up-Low       | 1,8            | aluminum adn black | 5,9         | 70606844**   |
|   | FX2-ESD/EX-D100-L1800-Down-Low     | 1,8            | Aluminum and black | 5,9         | 70607044***  |
|   | FX2-ESD/EX-D100-L1800-Down-Through | 1,8            | Aluminum and black | 5,2         | 70607144**** |
|  | FX2-ESD/EX-D100-L2400-Up-Low       | 2,4            | Aluminum and black | 6,9         | 70607244**   |

\*Up/Down-Low

\*\*Up-Low

\*\*\*Down-Low

\*\*\*\*Down-Through

# BenchTop Extraction Arm FX2 100 ESD/EX

|  | Accessory   | Part No  |
|--|---|----------|
|  | FX-Bracket kit-D50/75/100-L190  | 70501144 |
|  | FFX2-Bracket kit-D50/75/100-L500  | 70377042 |
|  | FX2-Bench bracket kit-D50/75/100  | 70501444 |
|  | FX-Classic bracket-D50/75/100   | 70501244 |
|  | FX-Cut2fit extension-L1100.   | 70501344 |
|  | FX-Cut2fit extension-L2200  | 70374600 |
|  | FX-Ceiling cover plate  | 70502644 |
|  | FX2-Ceiling cover plate-PLUS  | 70377045 |
|  | FX2-Wall BRKT kit-Flat-L190-Black.  | 70377044 |
|  | FX-Dome hood-ESD/EX-D50/75/100  | 70376983 |
|  | FX-Combi hood-ESD/EX-D50/75/100   | 70500244 |
|  | FX-Metal hood-ESD/EX-D50/75/100   | 70500544 |
|  | FX-Flange hood-ESD/EX-D50/75/100.   | 70502944 |
|  | FX2-Duct connector-ESD/EX-D100  | 70377041 |
|  | FX2-AI duct-L1000-D75/100toD100   | 70377058 |
|  | FX2-AI duct-L2000-D75/100toD100   | 70377059 |
|  | FX-Hose-ESD-D100-L3000-Black-<br>Flexible hose in black conductive PE with 100 mm (4 inch) diameter and 3000 mm (118.11 inch) length. It shall be used with hose support ring to connect hose to arm. | 70377102 |
|  | FX-Hose-ESD-D125-L5000-Black-<br>Flexible hose in black conductive PE with 125 mm (5 inch) diameter and 5000 mm (195.85 inch) length. It shall be used with hose support ring to connect hose to arm. | 70377103 |
|  | FX2-Hose support ring-D100  | 70377068 |
|  | FX2-Hose support ring-D125  | 70377069 |

## BenchTop Extraction Arm FX2 100 ESD/EX

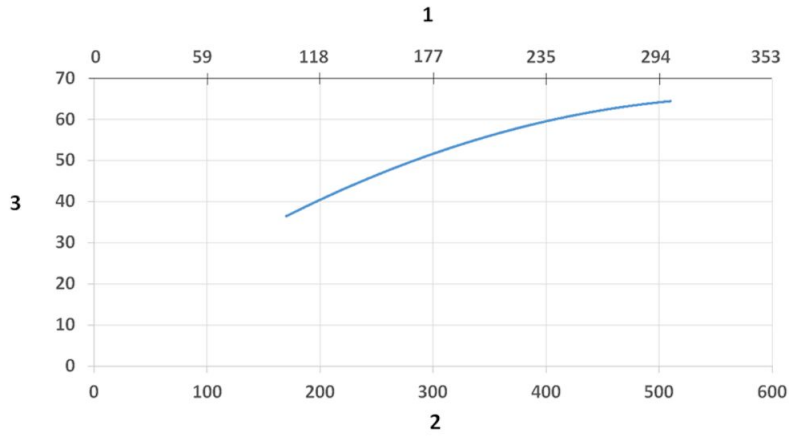

Sound Level diagram:

1) X- Axis: Air Flow Rate (cfm)

2) X- Axis: Air Flow Rate (m/h)

3) Y-Axis: Sound Pressure Level (dB) (A)

## BenchTop Extraction Arm FX2 100 ESD/EX

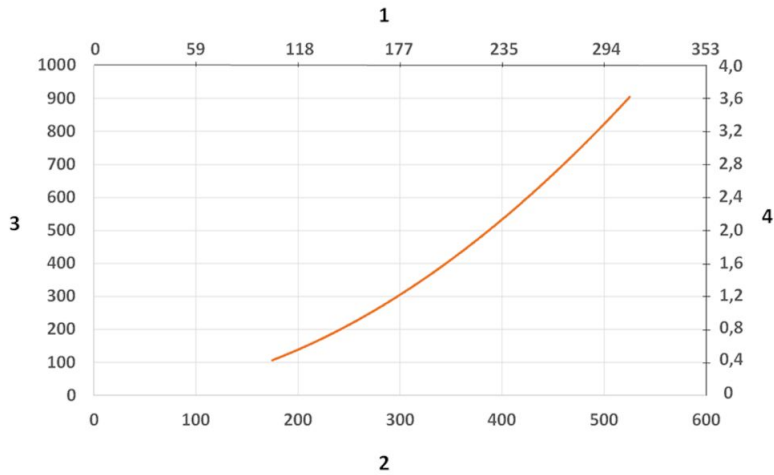

Pressure Drop diagram:

- 1) X- Axis: Air Flow Rate (cfm)
- 2) X- Axis: Air Flow Rate (m/h)

- 3) Y- Axis: Static Pressure Drop (Pa)
- 4) Y- Axis: Static Pressure Drop (in. wg.)

## BenchTop Extraction Arm FX2 100 ESD/EX

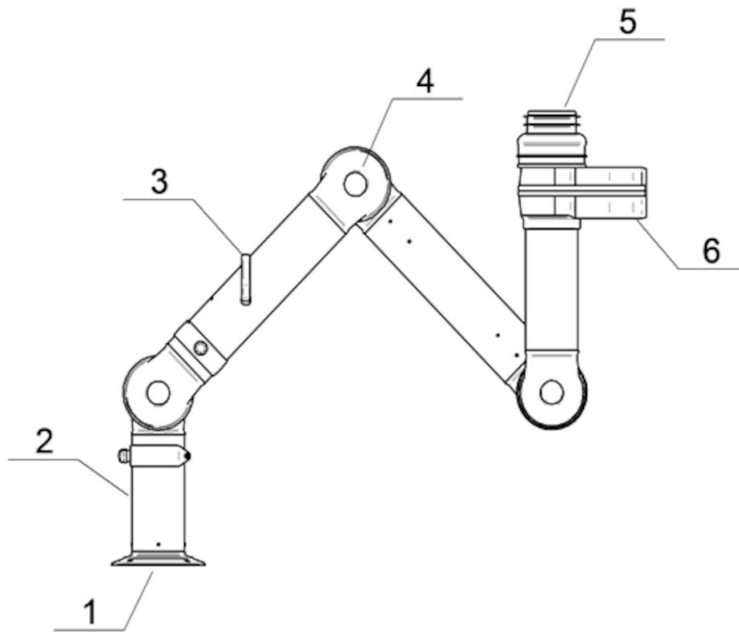

Material:

1) Flange: Conductive PP plastic

2) Tubes: Aluminum, anodized 10 µm

3) Damper adjustment handle: Aluminum: anodized 10 µm  
Internal spring: Stainless steel  
Damper blade: Conductive TP & PP plastic

4) Joints conductive: PP plastic with glass fibre reinforcement  
Plastic rings conductive: PP plastic with glass fibre reinforcement  
Axial locking rings conductive: PP plastic with glass fibre reinforcement  
Adjustment knobs: PA & EDS plastic  
Threaded shaft inside joints: Stainless Steel

5) Duct connector: conductive EPDM Rubber

6) Swivel: Aluminum, conductive powder coating  
Rivets: Aluminum  
Bearings swivel conductive: PP plastic with glass fibre reinforcement

## BenchTop Extraction Arm FX2 100 ESD/EX

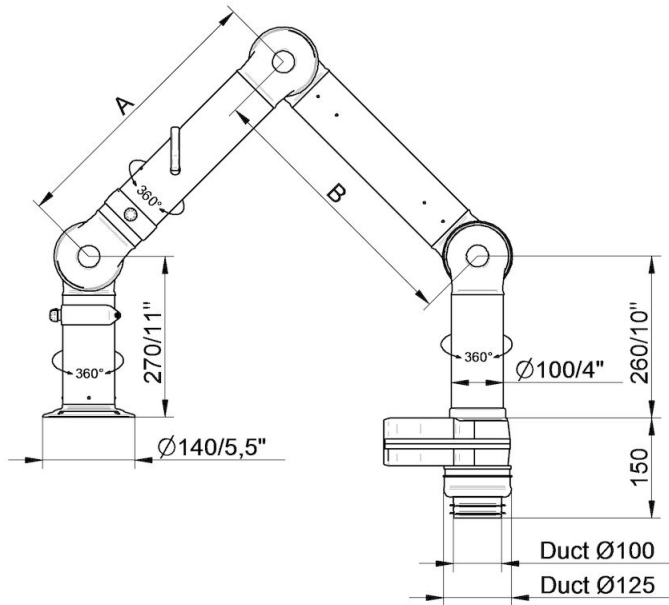

- FX2-ESD/EX-D100-L1200-Up/Down-Low  
Part number: 70606544  
Max. working radius: 1170 mm (46,1 in)  
A: 450 mm (17,7 in)  
B: 450 mm (17,7 in)

- FX2-ESD/EX-D100-L1800-Down-Low  
Part number: 70607044  
Max. working radius: 1770 mm (69,7 in)  
A: 750 mm (29,5 in)  
B: 750 mm (29,5 in)

## BenchTop Extraction Arm FX2 100 ESD/EX

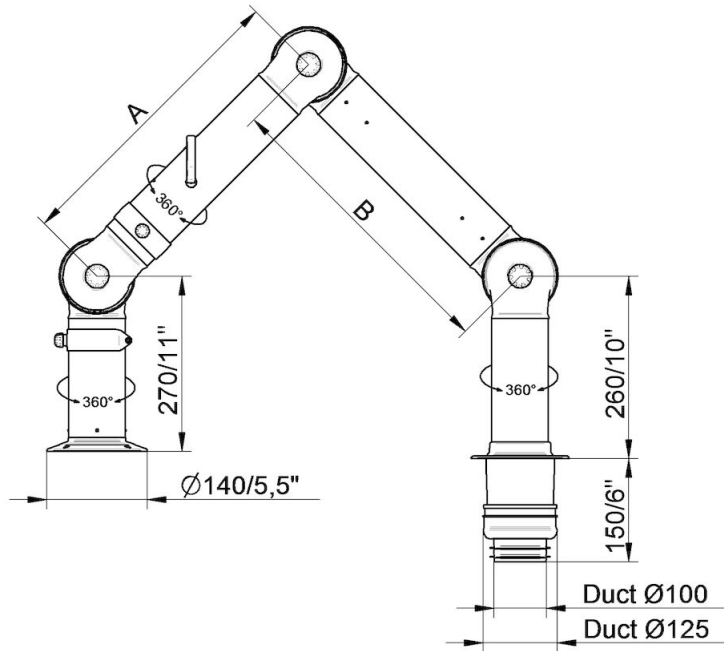

- FX2-ESD/EX-D100-L1200-Up/Down-Thru  
Part number: 70606744  
Max. working radius: 1170 mm (46,1 in)  
A: 450 mm (17,7 in)  
B: 450 mm (17,7 in)

- FX2-ESD/EX-D100-L1800-Down-Through  
Part number: 70607144  
Max. working radius: 1770 mm (69,7 in)  
A: 750 mm (29,5 in)  
B: 750 mm (29,5 in)



## BenchTop Extraction Arm FX2 100 ESD/EX

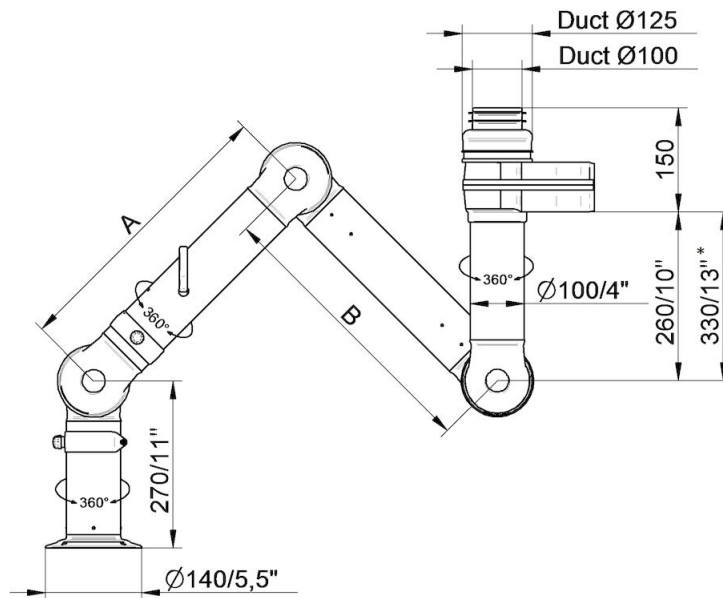

- FX2-ESD/EX-D100-L1200-Up/Down-Low  
Part number: 70606544  
Max. working radius: 1170 mm (46,1 in)  
A: 450 mm (17,7 in)  
B: 450 mm (17,7 in)

- FX2-ESD/EX-D100-L1800-Up-Low  
Part number: 70606844  
Max. working radius: 1770 mm (69,7 in)  
A: 750 mm (29,5 in)  
B: 750 mm (29,5 in)

- \* • FX2-ESD/EX-D100-L2400-Up-Low  
Part number: 70607244  
Max. working radius: 2290 (90,16 in)  
A: 1010 mm (39,7 in)  
B: 1010 mm (39,7 in)

## BenchTop Extraction Arm FX2 100 ESD/EX

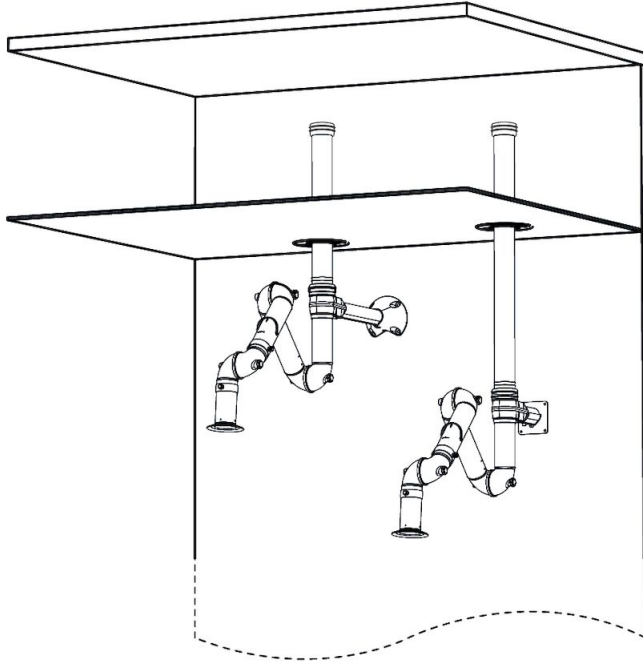

Wall mounting examples:

Left: FX2-Up-Low arm with following accessories:

- FX2-Bracket kit-D-50/75/100-L500
- FX2-Ceiling cover plate-PLUS
- FX2-Alu duct
- FX2-Duct connector-ESD/EX-D100

Right: FX2-Up-Low arm with following accessories:

- FX2-Wall BRKT kit-Flat-L190-Black
- FX2-Ceiling cover plate-PLUS
- FX2-Alu duct
- FX2-Duct connector-ESD/EX-D100

## BenchTop Extraction Arm FX2 100 ESD/EX



Bench mounting examples:

Left: FX2-Down-Low arm with following accessories:

-FX2-Bench bracket kit-D-50/75/100

Right: FX2-Down-Through arm

## BenchTop Extraction Arm FX2 100 ESD/EX

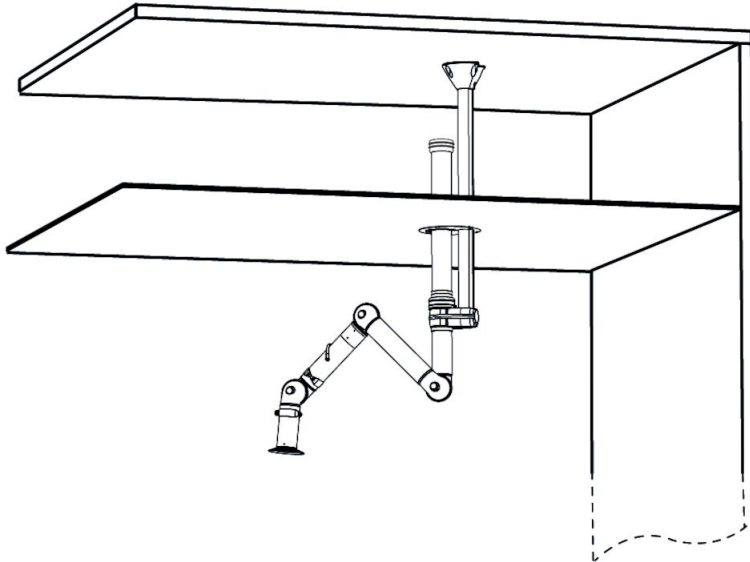

- Ceiling mounting example:  
FX2-Up-Low arm with following accessories:
- FX-Classic bracket
  - FX-Cut2fit extension-L1100
  - FX2-Alu duct
  - FX2-Duct connector-ESD/EX-D100
  - FX-Ceiling cover plate

## BenchTop Extraction Arm FX2 100 ESD/EX

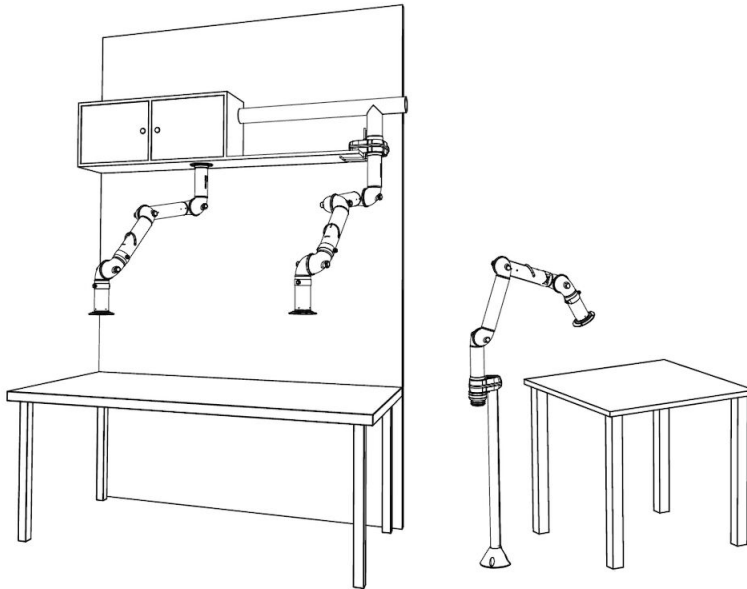

Other mounting examples:

Left: Overbench cabinet mounting with FX2-Up/Down-Through arm

Middle: Shelf mounting with FX2-Up-Low arm and following accessories:

-FX2-Bench bracket kit

Right: Floor mounting with FX2-Up-Low arm and following accessories:

-FX-Classic bracket

-FX-Cut2fit extension-L1100