

## Braço extrator de bancada FX2 100 Original

Solução de melhor custo-benefício para aplicações onde captos compactos, flexíveis e simples sejam necessários.

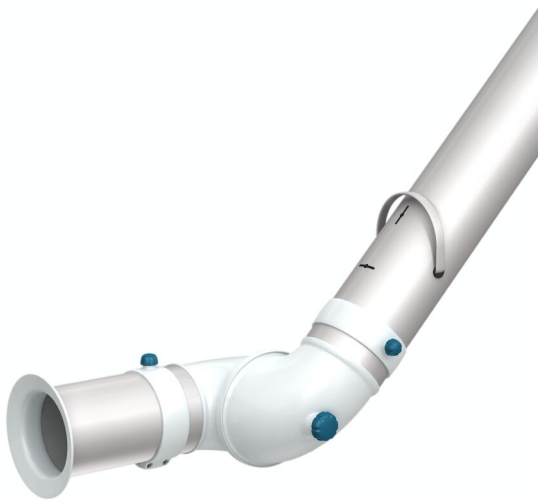

Os braços Nederman FX2 são fabricados em seções de alumínio anodizado leve, com dois ou três juntas de ajuste feitas em material composto. Oferecem resistência e durabilidade combinadas com fácil utilização em diversas aplicações. São especialmente indicados para aplicações onde captos compactos, flexíveis e simples são necessários.









Uma linha completa e confiável para aplicações triviais e outras onde existe risco de descargas elétricas ou substâncias corrosivas.

- Excelente eficiência e baixo nível de ruído garantem um ambiente de trabalho seguro e agradável.
- Suportes para fixação em teto, parede, pisos e bancadas, e os perfis de extensão Cut2fit garantem máxima flexibilidade de instalação.
- As justas externas permitem rotação 360° das seções do braço, garantindo total e exclusiva manobrabilidade.
- O desenho leve, suave e estético permite que os braços se adequem a qualquer ambiente sem comprometer sua durabilidade e confiabilidade.
- Produtos totalmente integrados que economizam tempo e custos, além de prover alta confiabilidade e funcionalidade.

Nome do Produto	Braço extrator de bancada FX2 100 Original
Nível de ruído (dB(A))	62 dB(A) at 450 m <sup>3</sup> /h
Instalação	Interior
Material	Tubes in anodized aluminium. Joints in PP plastic. Duct connectors in EPDM rubber. Minihood in PP plastic.
Temperatura dos fumos	max 70°C
Diâmetro do braço de extração (mm)	100
Caudal (m <sup>3</sup> /h)	200-450
Cor	Aluminum and white



## Braço extrator de bancada FX2 100 Original

[image]	Descrição	Comprimento do braço (m)	Peso (kg)	[model]
	FX2-ORIG-D100-L1200-Up/Down-Low	1,2	4,8	70604744*
	FX2-ORIG-D100-L1200-Up-PLUS	1,2	5,9	70604844**
	FX2-ORIG-D100-L1200-Up/Down-Thr	1,2	4,1	70604944***
	FX2-ORIG-D100-L1800-Up-Low	1,8	5,9	70605044****
	FX2-ORIG-D100-L1800-Up-PLUS	1,8	7,7	70605144**
	FX2-ORIG-D100-L1800-Down-Low	1,8	5,9	70605244*****
	FX2-ORIG-D100-L1800-Down-Through	1,8	5,2	70605344*****
	FX2-ORIG-D100-L2400-Up-Low	2,4	6,9	70605444****
	FX2-ORIG-D100-L2400-Up-PLUS	2,4	8,7	70605544**

\*Up/Down-Low

\*\*Up-PLUS

\*\*\*Up/Down-Through

\*\*\*\*Up-Low

\*\*\*\*\*Down-Low

\*\*\*\*\*Down-Through

## Braço extrator de bancada FX2 100 Original

	[accessory]	[partno]
	Suporte FX-Bracket kit-D50/75/100-L190.	70501144
	Suporte FX2-Bracket kit-D50/75/100-L500	70377042
	Suporte FX2-Wall BRKT FLAT-L190-White	70377043
	Suporte FX2-Wall-P BRKT D50/75/100-L190	70377046
	Suporte de bancada FX2 D50/75/100	70501444
	Suporte FX-Classic D50/75/100	70501244
	Extensão FX-Cut2fit L1100.	70501344
	Extensão FX-Cut2fit L2200.	70374600
	Tampa FX-Ceiling cover plate	70502644
	Tampa FX-Ceiling cover plate PLUS	70377045
	Coifa FX-Combi ORIGINAL-D50/75/100.	70500144
	Coifa FX-Dome ORIGINAL-D50/75/100.	70376982
	Coifa FX-Metal ORIG/CHEM-D50/75/100.	70500444
	Coifa FX-Flange ORIGINAL-D50/75/100	70502844
	Conector FX2-Duct connector-ORIG/CHEM-D100	70377040
	Duto FX2-Al duct-L1000-D75/100toD100	70377058
	Duto FX2-Al duct-L2000-D75/100toD100	70377059
	FX2-Hose support ring-D100	70377068
	FX2-Hose support ring-D125	70377069

## Braço extrator de bancada FX2 100 Original

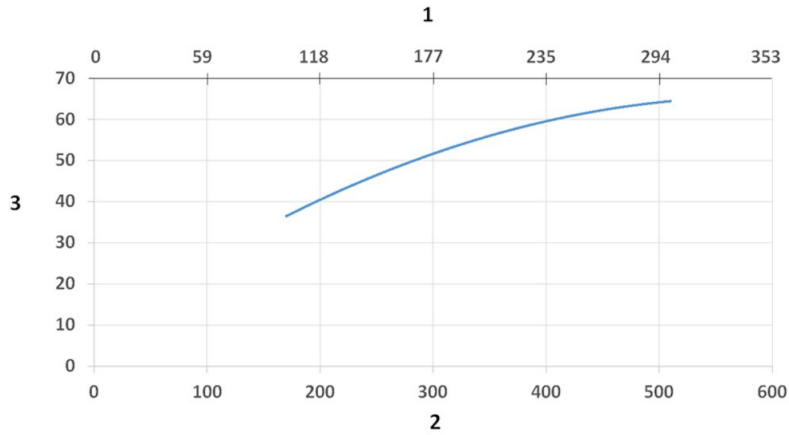

Sound Level diagram:

1) X- Axis: Air Flow Rate (cfm)

2) X- Axis: Air Flow Rate (m/h)

3) Y-Axis: Sound Pressure Level (dB) (A)

## Braço extrator de bancada FX2 100 Original

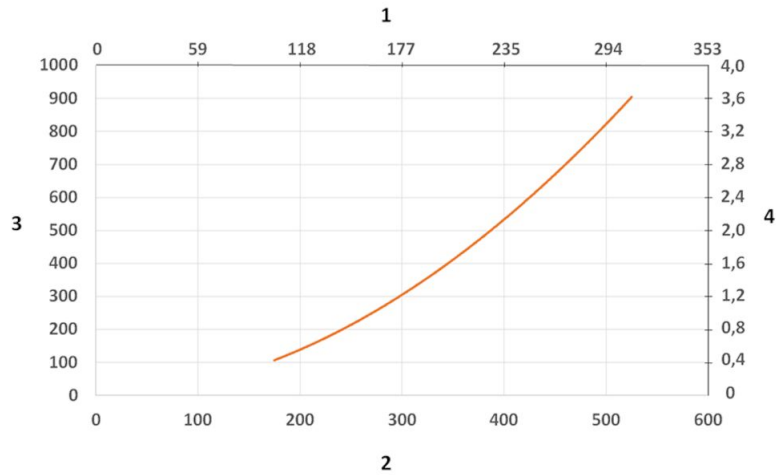

Pressure Drop diagram:

- 1) X- Axis: Air Flow Rate (cfm)
- 2) X- Axis: Air Flow Rate (m/h)

- 3) Y- Axis: Static Pressure Drop (Pa)
- 4) Y- Axis: Static Pressure Drop (in. wg.)

## Braço extrator de bancada FX2 100 Original



Material:

1) Flange: Polipropileno

2) Tubos: Alumínio anodizado 10 µm

3) Alça do damper: Alumínio anodizado 10 µm  
Mola interna: aço inoxidável  
Swivel em Polipropileno com reforço em fibra de vidro  
Chapa do damper: Elastômero termoplástico

4) Juntas: polipropileno com reforço em fibra de vidro  
Anéis plásticos: polipropileno com reforço em fibra de vidro  
Anéis de travamento: polipropileno com reforço em fibra de vidro  
Botões de ajuste: polipropileno com fibra de vidro reforçado com aço galvanizado  
Juntas internas do eixo: Aço inoxidável

5) Conector do tubos: EPDM borracha

6) Swivel: Alumínio, pintura PP  
Rebites: Alumínio

## Braço extrator de bancada FX2 100 Original

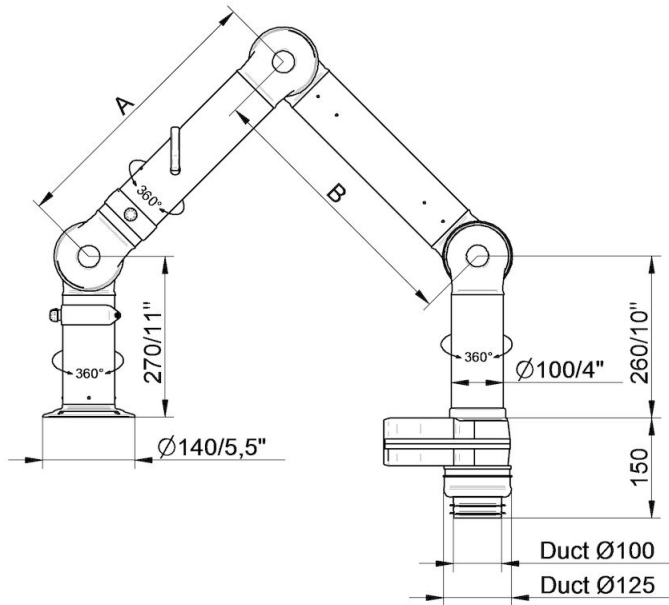

- FX2-ORIG-D100-L1200-Up/Down-Low  
Part number: 70604744  
Max. working radius: 1170 mm (46,1 in)  
A: 450 mm (17,7 in)  
B: 450 mm (17,7 in)

- FX2-ORIG-D100-L1800-Down-Low  
Part number: 70605244  
Max. working radius: 1770 mm (69,7 in)  
A: 750 mm (29,5 in)  
B: 750 mm (29,5 in)

## Braço extrator de bancada FX2 100 Original

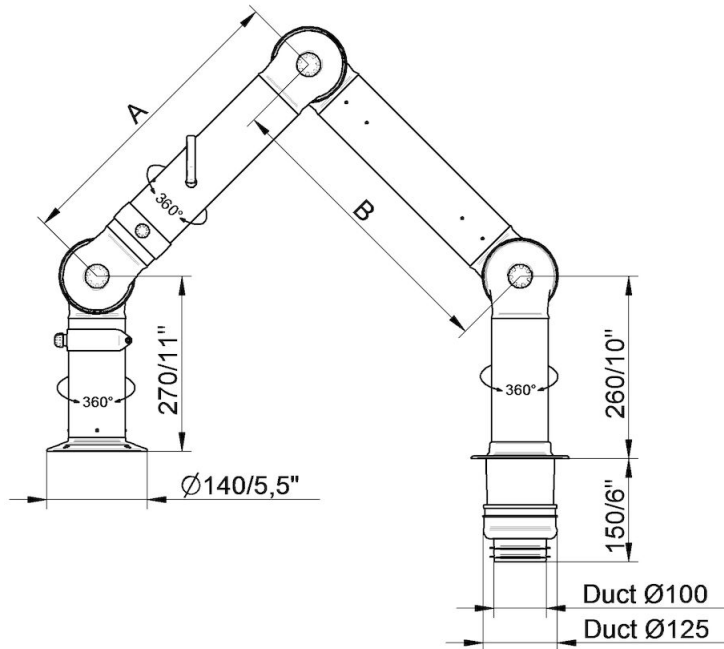

- FX2-ORIG-D100-L1200-Up/Down-Through  
Part number: 70604944  
Max. working radius: 1170 mm (46,1 in)  
A: 450 mm (17,7 in)  
B: 450 mm (17,7 in)

- FX2-ORIG-D100-L1800-Down-Through  
Part number: 70605344  
Max. working radius: 1770 mm (69,7 in)  
A: 750 mm (29,5 in)  
B: 750 mm (29,5 in)



## Braço extrator de bancada FX2 100 Original

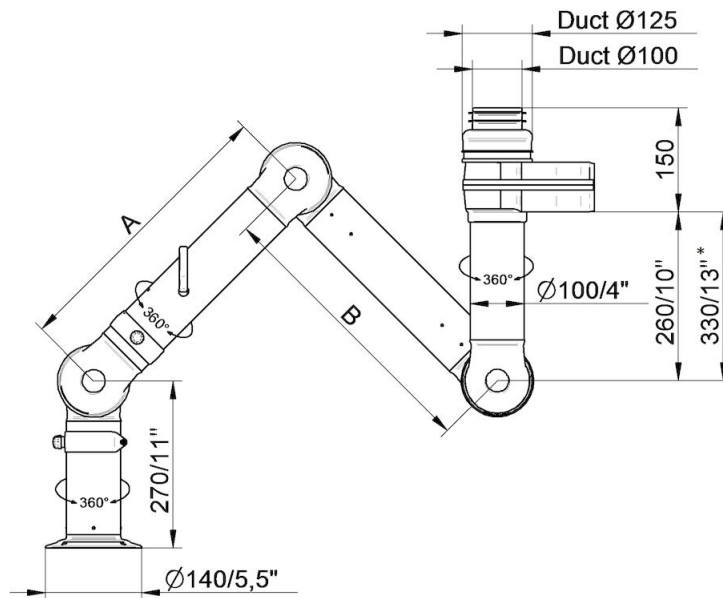

- FX2-ORIG-D100-L1200-Up/Down-Low  
Part number: 70604744  
Max. working radius: 1170 mm (46,1 in)  
A: 450 mm (17,7 in)  
B: 450 mm (17,7 in)

- FX2-ORIG-D100-L1800-Up-Low  
Part number: 70605044  
Max. working radius: 1770 mm (69,7 in)  
A: 750 mm (29,5 in)  
B: 750 mm (29,5 in)

- \*  
• FX2-ORIG-D100-L2400-Up-Low  
Part number: 70605444  
Max. working radius: 2290 mm (90,2 in)  
A: 1010 mm (39,7 in)  
B: 1010 mm (39,7 in)

## Braço extrator de bancada FX2 100 Original

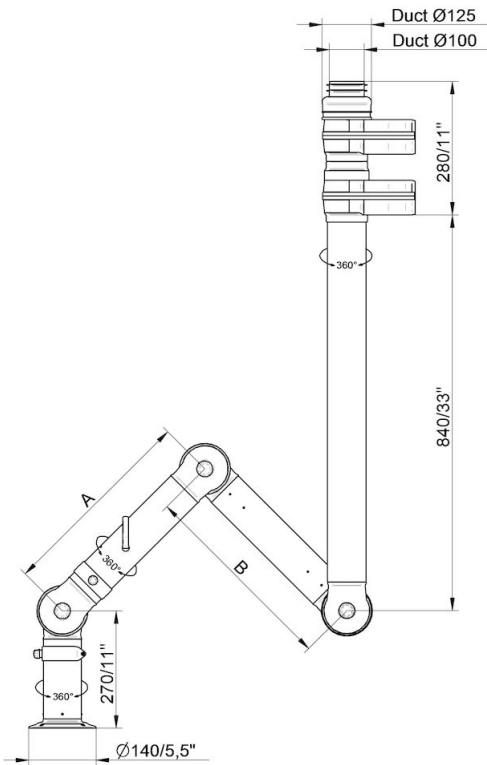

FX2-ORIG-D100-L1200-Up-PLUS  
 Part number: 70604844  
 Max. working radius: 1170 mm (46,1 in)  
 A: 450 mm (17,7 in)  
 B: 450 mm (17,7 in)

- FX2-ORIG-D100-L1800-Up-PLUS  
 Part number: 70605144  
 Max. working radius: 1770 mm (69,7 in)  
 A: 750 mm (29,5 in)  
 B: 750 mm (29,5 in)

- FX2-ORIG-D100-L2400-Up-PLUS  
 Part number: 70605544  
 Max. working radius: 2290 mm (90,2 in)  
 A: 1010 mm (39,7 in)  
 B: 1010 mm (39,7 in)

## Braço extrator de bancada FX2 100 Original



Bench mounting examples:

Left: FX2-Down-Low arm with following accessories:

-FX2-Bench bracket kit-D50/75/100

Right: FX2-Down-Through arm

## Braço extrator de bancada FX2 100 Original

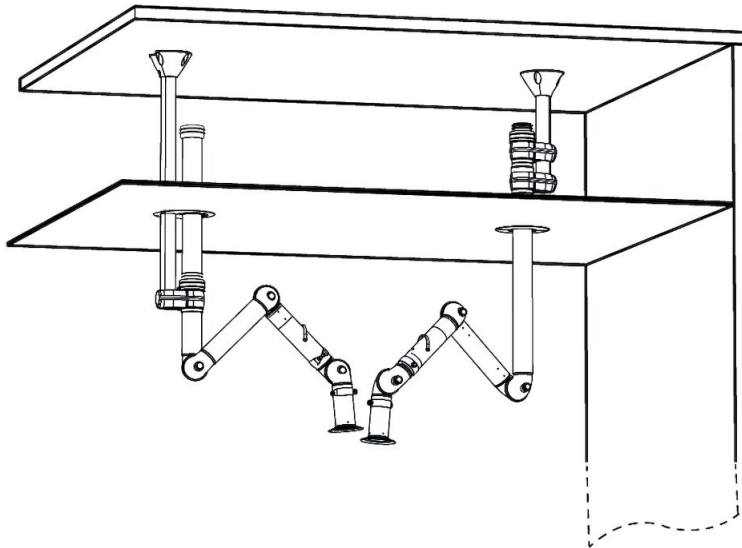

Ceiling mounting example:

Left: FX2-Up-Low arm with following accessories:

- FX-Classic bracket
- FX-Cut2fit extension-L1100
- FX2-Alu duct
- FX2-Duct connector-ORIG/CHEM-D100
- FX-Ceiling cover plate

Right: FX2-Up-PLUS arm with following accessories:

- FX2-Bracket kit-D50/75/100-L500
- FX2-Ceiling cover plate-PLUS

## Braço extrator de bancada FX2 100 Original

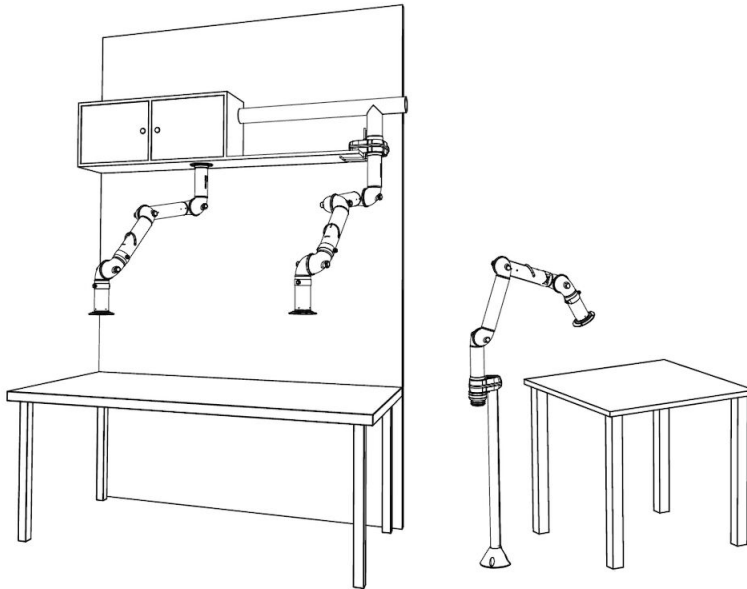

Other mounting examples:

Left: Overbench cabinet mounting with FX2-Up/Down-Through arm

Middle: Shelf mounting with FX2-Up-Low arm and following accessories:

-FX2-Bench bracket kit

Right: Floor mounting with FX2-Up-Low arm and following accessories:

-FX-Classic bracket

-FX-Cut2fit extension-L1100

## Braço extrator de bancada FX2 100 Original

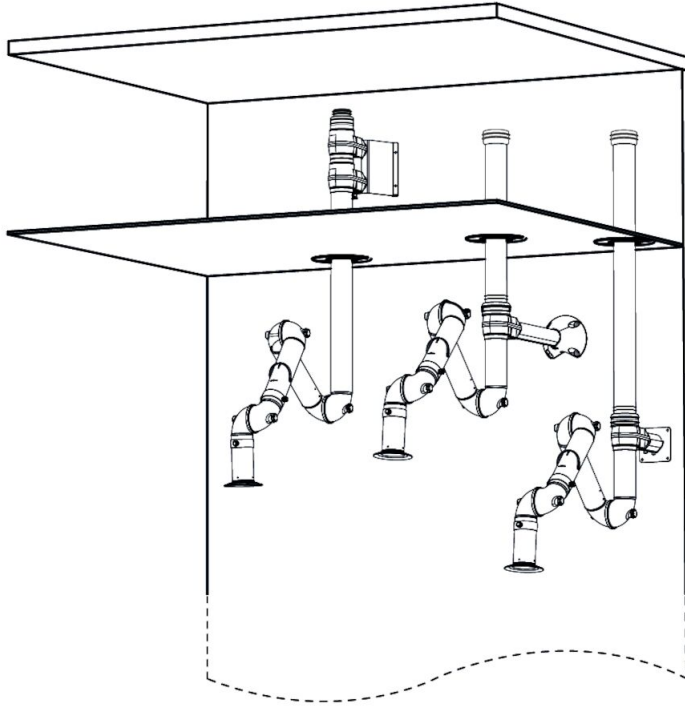

Wall mounting examples:

Left: FX2-Up-PLUS arm with following accessories:

- FX2-Wall-P BRKT kit-D50/75/100-L190
- FX2-Ceiling cover plate-PLUS

Middle: FX2-Up-Low arm with following accessories:

- FX2-Bracket kit-D50/75/100-L500
- FX2-Ceiling cover plate-PLUS
- FX2-Alu duct
- FX2-Duct connector-ORIG/CHEM-D100

Right: FX2-Up-Low arm with following accessories:

- FX2-Wall BRKT kit-Flat-L190-White
- FX2-Ceiling cover plate-PLUS
- FX2-Alu duct
- FX2-Duct connector-ORIG/CHEM-D100