

## NCF-vifter

---

















Nederman NCF-viftene har direkte drivmotorer som betyr en sikker og kostnadseffektiv drift. Å installere en energieffektiv NCF-vifte med våre andre Nederman-produkter sparer tid og reduserer energikostnader. Det er en radialvifte beregnet for bruk i alle typer av industrielle prosesser og ventilasjon - montert innendørs og utendørs. Viften er utstyrt med vibrasjonsdempere som standard.

---

Produktnavn	NCF-vifter
Beskyttelsesklasse:	IP 55
Installasjon	Utendørs, Innendørs
Materiale	Sheet metal, painted grey, RAL 7045
Ambient temperature range	-30 to +40 °C (22 F to 104 F)
Driftstemperatur	Max. 60 °C
Frekvens Hz	50
Antall faser	3











## NCF-vifter

Bilde	Navn på datablad	Spenning (V)	Strømstyrke (A)	Noise level (dB(A))	Vekt (kg)	Kraft (kW)	Model
	VIFTE NCF120/15	230/400	24,0/13,8	85 db(A) at 10000 m <sup>3</sup> /h	123	7,5	14550228
	VIFTE NCF30/15	230/400	7,9 / 4,6	69 db(A) at 2500 m <sup>3</sup> /h	67	2,2	14550128
	VIFTE NCF30/25	230/400	13,6/7,8	74 db(A) at 4000 m <sup>3</sup> /h	105	4	14550328
	VIFTE NCF40/25	230/400	17,9/10,3	75 db(A) at 4000 m <sup>3</sup> /h	110	5,5	14550428
	VIFTE NCF50/25	230/400	17,9/10,3	78 db(A) at 3500 m <sup>3</sup> /h	112	5,5	14550528
	VIFTE NCF80/20	230/400	24,0/13,8	77 db(A) at 6000 m <sup>3</sup> /h	150	7,5	14550628
	VIFTE NCF120/25	230/400	46,1/26,5	82 db(A) at 8000 m <sup>3</sup> /h	232	15	14550728
	VIFTE NCF160/25	230/400	56,5/32,5	84 db(A) at 10000 m <sup>3</sup> /h	292	18,5	14550828
	VIFTE NCF120/15	400/690	13,8/8,0	85 db(A) at 10000 m <sup>3</sup> /h	123	7,5	14550928
	VIFTE NCF30/25	400/690	7,8/4,5	74 db(A) at 4000 m <sup>3</sup> /h	105	4	14551028
	VIFTE NCF40/25	400/690	10,3/6,0	75 db(A) at 4000 m <sup>3</sup> /h	110	5,5	14551128
	VIFTE NCF50/25	400/690	10,3/6,0	78 db(A) at 3500 m <sup>3</sup> /h	112	5,5	14551228
	VIFTE NCF80/20	400/690	13,8/8,0	77 db(A) at 6000 m <sup>3</sup> /h	150	7,5	14551328
	VIFTE NCF120/25	400/690	26,5/15,3	82 db(A) at 8000 m <sup>3</sup> /h	232	15	14551428
	VIFTE NCF160/25	400/690	32,5/18,8	84 db(A) at 10000 m <sup>3</sup> /h	292	18,5	14551528

## NCF-vifter

Tilbehør		Artikkelnummer
	Innløpsadap.. d250,30/15,40/25,50/25	14374438
	Innløpsadapter d315,30/25	14374439
	Innløpsadapter d400,80/20,120/25	14374440
	Innløpsadapter d500,120/15,160/25	14374441
	Utl.adap..288x205 d315,30/15,40/25	14374442
	Utløpsadapter 322x229 d400,30/25	14374443
	Utl.adap..361x256 d400,80/20,120/25	14374444
	Utl.adap..453x322d500,120/15,160/25	14374445
	Utl.adap..256x183 d250,50/25,30/20	14374446
	Fleks.inl.ad.d250,30/15,40/25,50/25	14374447
	Fleksibel innløpsadapter d315,30/25	14374448
	Fleks.innløp.adap.d400,80/20,120/25	14374449
	Fleks.innløp.adap.d500,120/15,160/25	14374450
	Fleks. utl.a.288x205 d315,30/15,40/25	14374451
	Fleks.utløpsadap.322x229 d400,30/25	14374452
	Fleks. utl.a.361x256d400,80/20,120/25	14374453
	Fleks. utl.a.453x322d500,120/15,160/25	14374454
	Fleks. utl.a.256x183 d250,50/25,30/20	14374455
	Innløpsgitter d250,30/15,40/25,50/25	14374456
	Vernegitter innløp d315,30/25	14374457
	Vernegitter innløp d400,80/20,120/25	14374458
	Vernegitter innløp d500,120/15,160/25	14374459

## NCF-vifter

	Tilbehør	Artikkelnummer
	Vernegitter utløp,30/15,40/25	14374460
	Vernegitter utløp,30/25	14374461
	Vernegitter utløp,80/20,120/25	14374462
	Vernegitter utløp,120/15,160/25	14374463
	Vernegitter utløp,50/25	14374464
	Vibrasjonsdemper AM 40,1 sett	14374624
	Vibrasjonsdemper AM 30,1 sett	14374628
	Vibrasjonsdemper AM 25,1 sett	14374629
	Vibrasjonsdemper AM 50,1 sett	14374630
	Innløpsadapter d250,30/20	14375076
	Fan starter 5,5kW (2,2 - 5,5 kW motor power)	14514837
	Fan starter 11kW (4,0 - 11,0 kW motor power)	14514937
	Fan starter 18,5kW (15,0 - 18,5 kW motor power)	14515037
	Fan starter 22kW (18,5 - 22,0 kW motor power)	14515537
	Frekvensomformer for 5,5 kW motorkraft	14522037*
	Frekvensomformer for 7,5 kW motorkraft	14522137**
	Frekvensomformer for 11 kW motorkraft	14522237**
	Frekvensomformer for 15 kW motorkraft	14522637**
	Frekvensomformer for 18,5 kW motorkraft	14525137**
	Frekvensomformer for 22 kW motorkraft	14525237**

\*Trykksensor 2000 Pa

\*\*Trykksensor 5000 Pa

## NCF-vifter

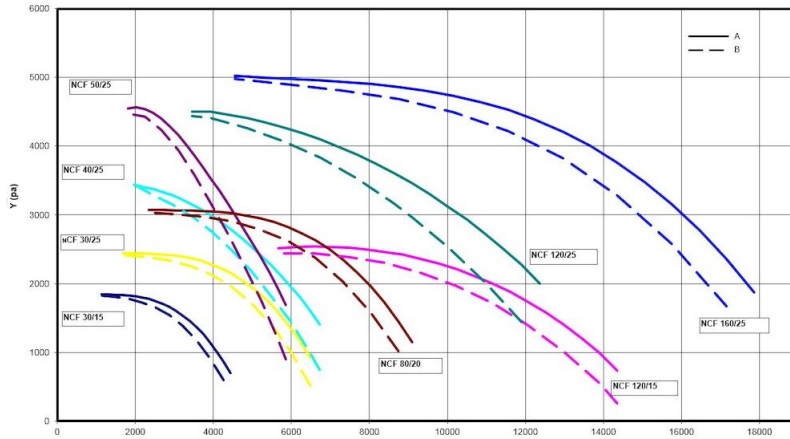

Y = Pressure drop

X = Air flow

A = Total pressure

B = Static pressure

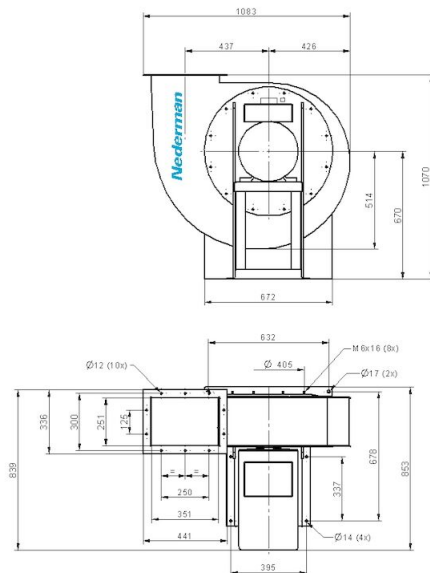

Fan NCF 120/25

Duct inlet diameter 400 mm

Duct outlet diameter 400 mm

## NCF-vifter

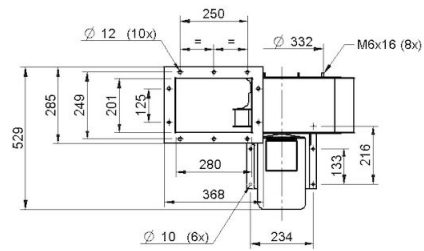
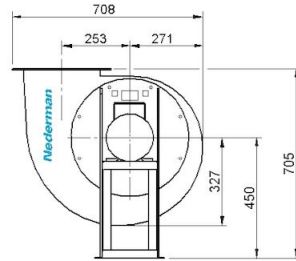

NCF 30/15

Duct inlet diameter 250 mm

Duct outlet diameter 315 mm

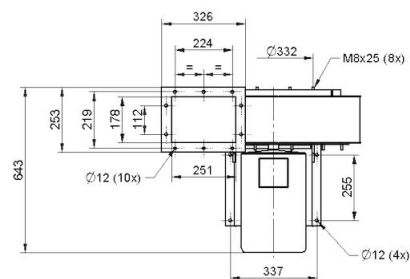
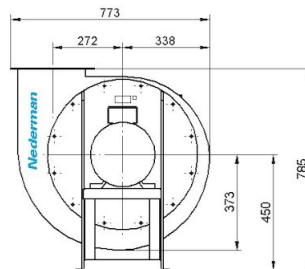

NCF 50/25

Duct inlet diameter 250 mm

Duct outlet diameter 250 mm

## NCF-vifter

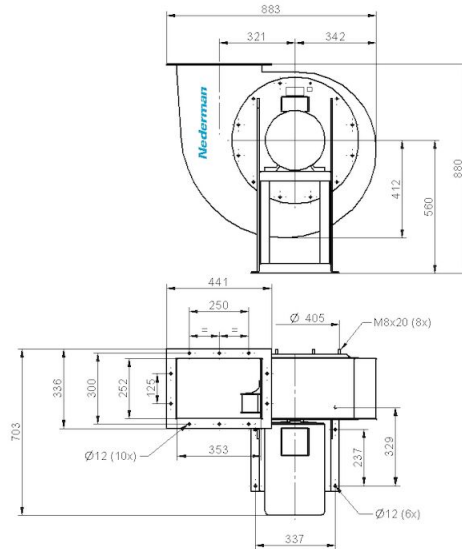

NCF 80/20

Duct inlet diameter 400 mm

Duct outlet diameter 400 mm

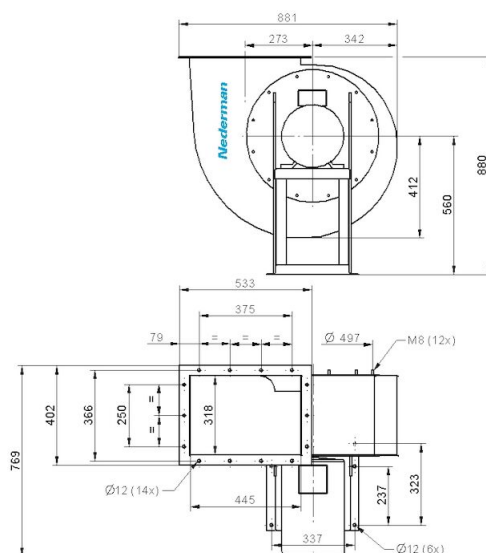

NCF 120/15

Duct inlet diameter 500 mm

Duct outlet diameter 500 mm

## NCF-vifter

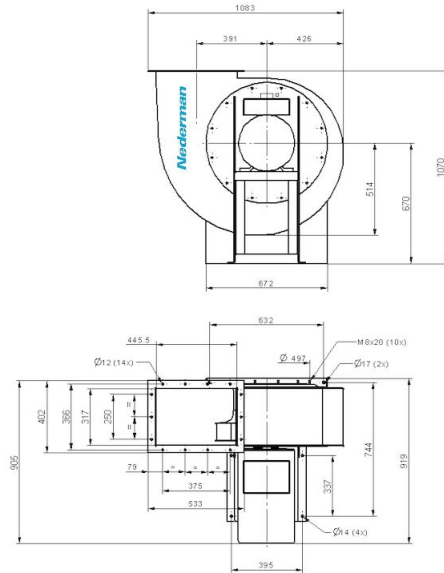

NCF 160/25

Duct inlet diameter 500 mm

Duct outlet diameter 500 mm

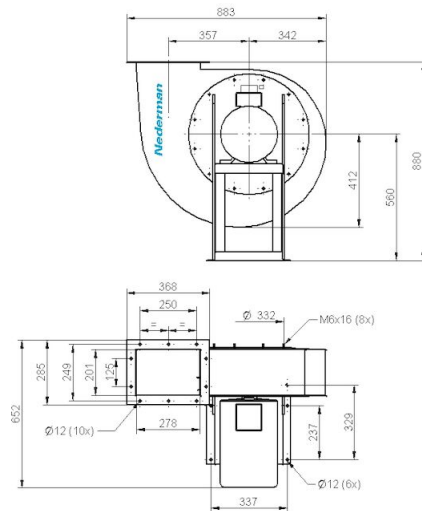

NCF 40/25

Duct inlet diameter 250 mm

Duct outlet diameter 315 mm



## NCF-vifter

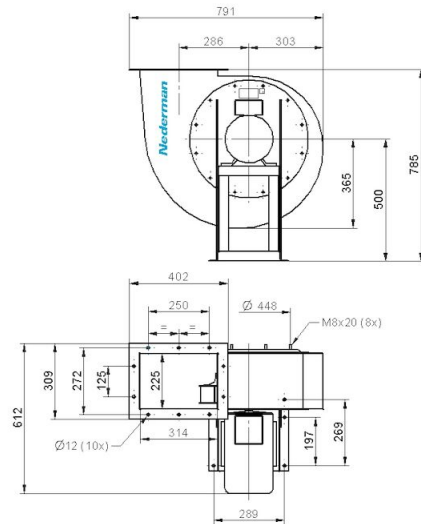

NCF 30/25

Duct inlet diameter 315 mm

Duct outlet diameter 400 mm