

OSF 1000 FC

FibreDrain® oil smoke collector for continuous operation.



Nederman OSF oil smoke eliminators are designed to handle large amounts of neat oil mist during continuous operation. They are developed with focus on high efficient filtration together with low maintenance cost.



Nederman OSF 1000 FC has as standard 3 filter-stages where the first 2 stages consists of filter cassettes with Nederman's FibreDrain® technology. Nederman have a wide range of different types of filters to suit many different kind of applications. The third stage consists of a HEPA filter in filter class H13 with an efficiency of 99,95% for MPPS according to EN1822. OSF 1000 FC have an built-in radial fan.

- Three filter stages
- Gauges for reading of pressure drop over each filter stage
- Compact design
- Two inlet \varnothing 200 mm with clamp ring connection
- Starter and motor protection included

| | |
|------------------------------------|--|
| Product name | OSF 1000 FC |
| Standard | 2009/125/EC |
| Volume (for shipping) (m³) | 1.72 |
| Noise level (dB(A)) | 50 Hz: 65 dB(A) @1,5 m from service side 60 Hz: 67 dB(A) @1,5 m from service side |
| Protection class | IP55 |
| Filter efficiency (%) | 99,95 |
| Installation | [Indoor] |
| Material | Sheet metal, painted both in- and outside. |
| Filter cleaning method | Self-Draining |
| Working pressure (kPa) | Max 2500 Pa |
| Capacity (max airflow m³/h) | 1000 |
| Operating Temperature | 40 deg C (inbuilt fan) |
| Power Voltage (V) | 230/400 |
| Frequency (Hz) | 50 |
| No of phases | 3 |
| Number of filter elements | 3 |
| Amperage (A) | 4,2 / 2,4 |
| Colour | NCS-S 1005 B20G |
| Weight (kg) | 200 |
| Power (kW) | 1,1 |
| Note | |



OSF 1000 FC

| [image] | Description | [model] |
|---|---|----------|
|  | OSF 1000 FC, Inlet Right or Back ø 200 mm clamp ring. Drain 1" Female | 12400005 |
|  | OSF 1000 FC, Inlet Left or Back ø 200 mm clamp ring. Drain 1" Female | 12400196 |

OSF 1000 FC

| [accessory] | | [partno] |
|---|--|-------------|
|  | Drain pump box, 60 Hz, 10 litre/min at 10m, excluding controller | 12401331* |
|  | Drain pump box, 50 Hz | 12400054** |
|  | Drain container with piping | 12400764*** |
|  | Frequency Inverter 1,1 kW incl transmitter 0 - 2 kPa | 12400845 |
|  | FibreDrain Filter 1 OSF; 600x600x292 mm | 12400006 |
|  | FibreDrain Filter 2 OSF; 600x600x292 mm | 12400007 |
|  | HEPA Filter H13; 610x610x150 mm | 12400852 |
|  | High capacity HEPA-filter kit for FC: 4 pcs distance holders and 1 pc HEPA filter 610x610x292mm | 12400984 |
|  | Outlet connection OSF 1000FC / OMF 2000FC - HEPA 610x610x292mm | 12400726 |
|  | Outlet connection OSF 1000FC / OMF 2000FC - HEPA 610x610x150mm | 12400959 |
|  | Drain pump box, 50 Hz, 10 litre/min at 10m, including controller | 12401330 |

*Controller available on request

**Drain connection must be elevated min 200 mm from pump box support level

***Drain connection must be elevated min 420mm from container support level

OSF 1000 FC

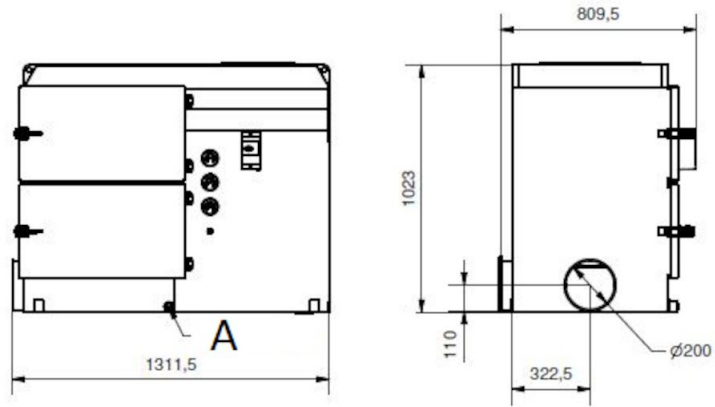

A) Drain stud (x2)

Dimensions for outlet connection:

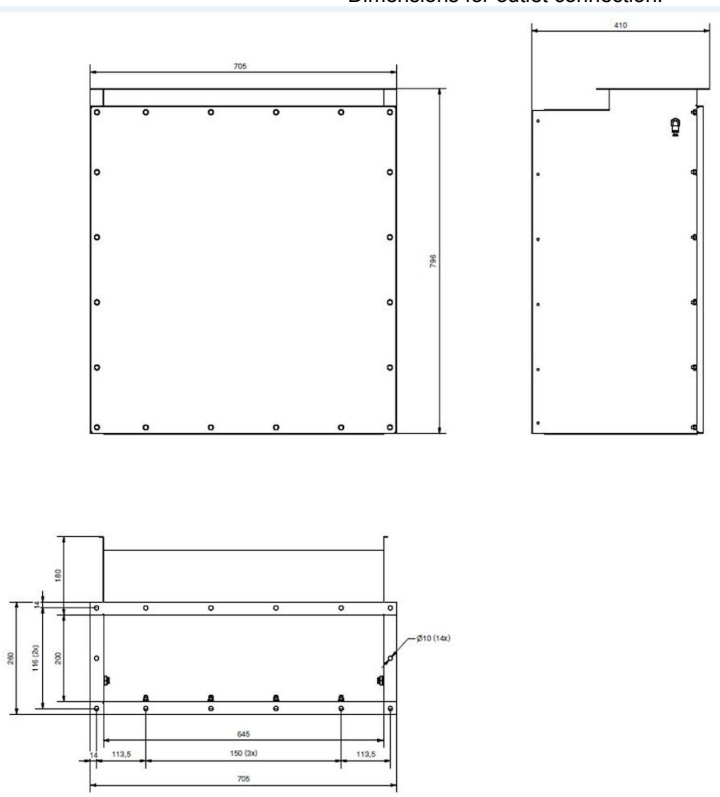

OSF 1000 FC

Dimensions for outlet connection:

