

Bench Top Extraction arm FX32 ESD

Flexible bench top extraction arm

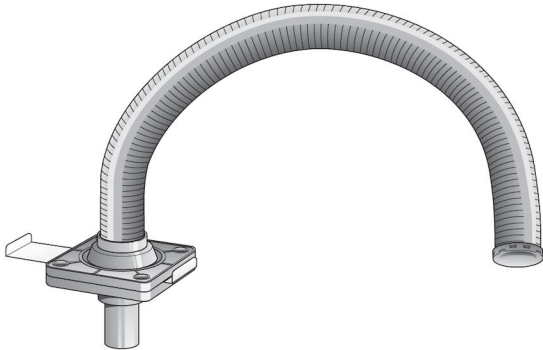

Extractor arms for use in electronic industries, laboratories, schools etc. Flexible plastic hose with a very good resistancy against solvents etc. Stays in new position when adjusted. ESD safe. Swivel with 360 degree rotation. This means that the connected ductwork remains firm and does not rotate with the arm. Mounting directly in bench surface or with accessory brackets. Can be mounted both standing and hanging.





| | |
|------------------------------|-----------------------------------|
| Product name | Bench Top Extraction arm FX32 ESD |
| Noise level (dB(A)) | 48 |
| Installation | Indoor |
| Extraction arm diameter (mm) | 32 |
| Airflow (m ³ /h) | 20-45 |
| Arm length (m) | 0,85 |



Bench Top Extraction arm FX32 ESD

| Description | Model |
|--------------------------|----------|
| FX 32 extraction arm ESD | 70502934 |

Bench Top Extraction arm FX32 ESD

| Accessory | | Part No |
|---|------------------------------------|----------|
|  | Dome hood 1/2 for FX 32 ESD | 70371807 |
|  | Dome hood 1/1 for FX 32 ESD | 70371808 |
|  | Table bracket, 75/50/32 Std/ESD/PP | 70371761 |
|  | Wall bracket FX 32 Std/ESD/PP | 70371760 |

Bench Top Extraction arm FX32 ESD

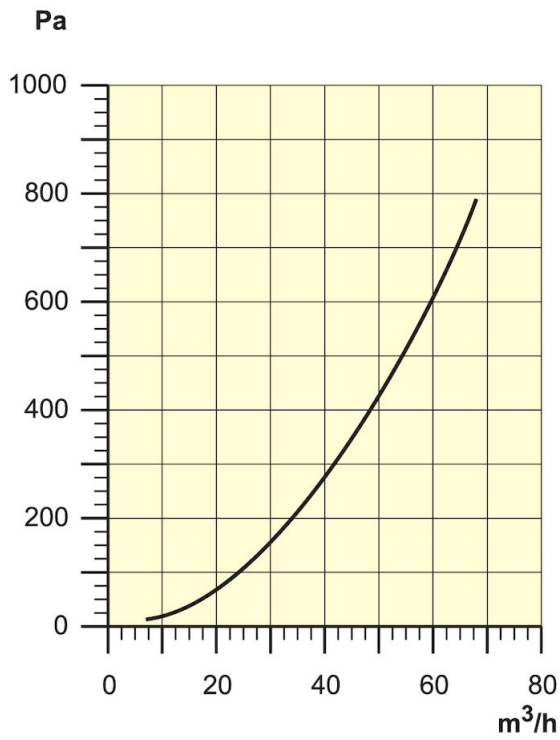

Pressure Drop

Bench Top Extraction arm FX32 ESD

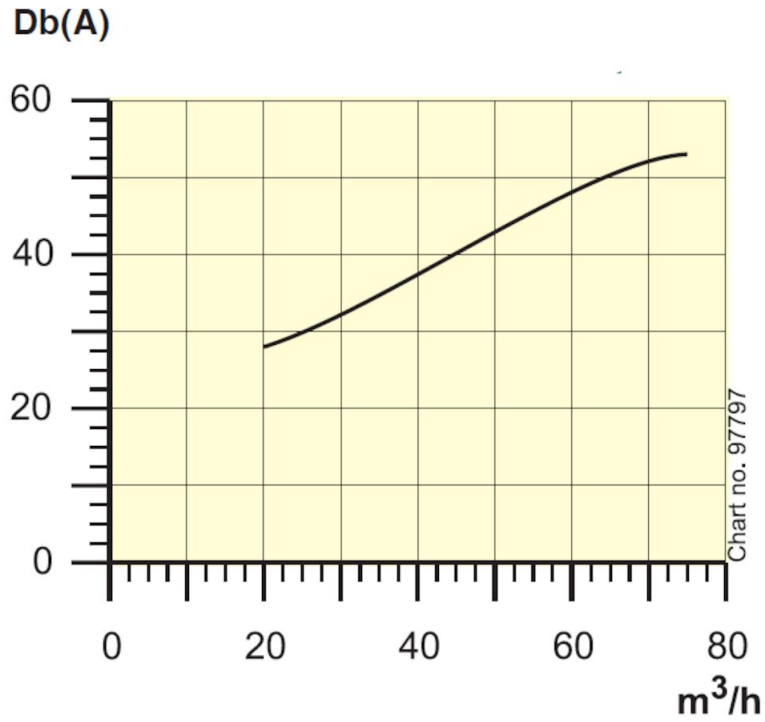

Sound Level
Distance to measuring point = 1m

Bench Top Extraction arm FX32 ESD

