

Instruction manual – Exhaust Nozzle with internal attachment

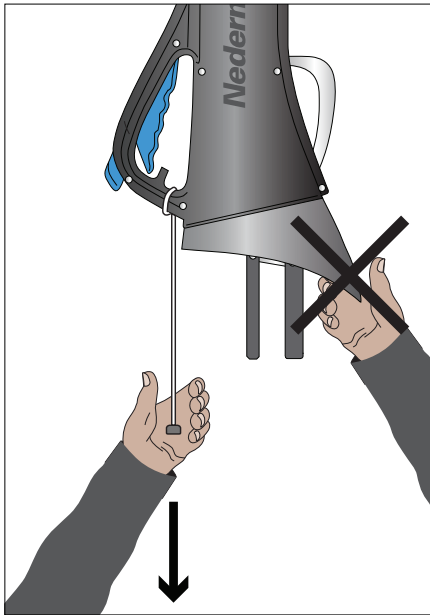

NOTE! Only use the extension rope to pull down the nozzle.

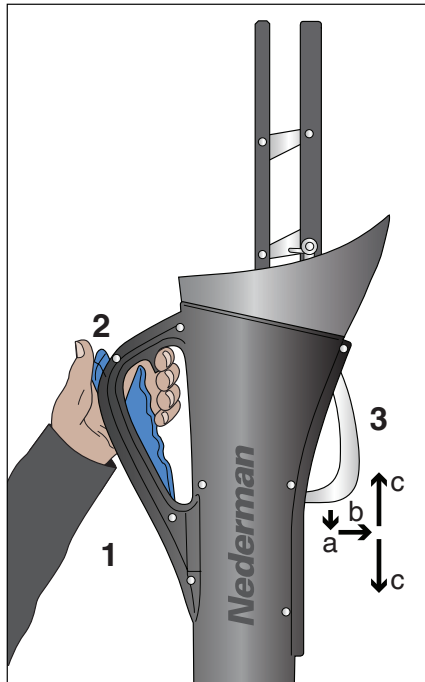

Changing the position of the nozzle pliers

1. Hold the nozzle in an upright position.
2. Push the button. **NOTE!** Do not press the handle.
3. Pull the linkage:
 - a) slightly downwards.
 - b) outwards.
 - c) upwards or downwards for new position of the nozzle pliers.

Normal position of the nozzle pliers for enclosed exhaust pipes

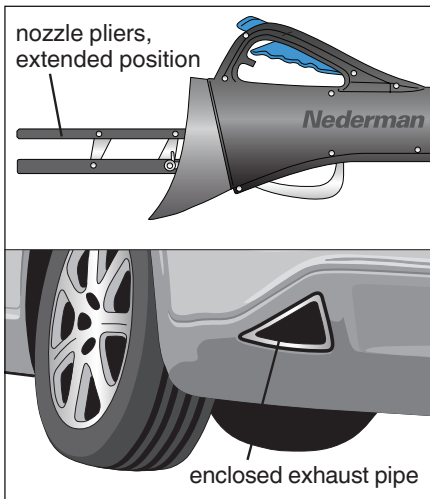

Normal position of the nozzle pliers for protruding exhaust pipes

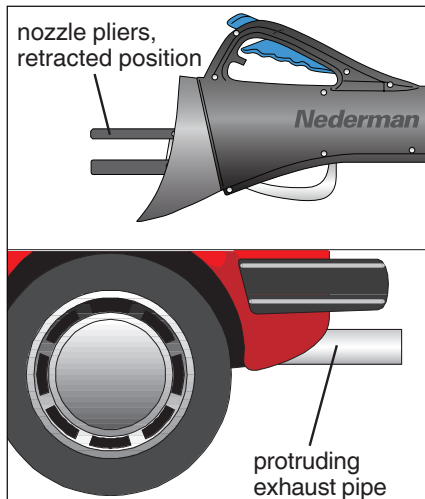

NOTE! If possible and no matter what type of exhaust pipe, try to fit the nozzle with the pliers in the extended position. If the nozzle does not come close enough to the coachwork for efficient capture of the exhaust gases, the pliers must be adjusted to the retracted position.

Technical data

Application	For stationary vehicles. Must not be used for vehicles in motion.
Rec. exhaust pipe dimension	50 – 65 mm diameter
Hose dimension	100 mm (4") diameter
Temperature resistance	Maximum 180 °C
Weight	2.2 kg
Material recycling	100 weight-%
Material	Polyamide, steel, EPDM-rubber

SAFETY REGULATIONS!

WARNING! Risk of personal injuries and/or product damages.

- The nozzle is designed for use only with stationary vehicles. When the nozzle has been connected to the exhaust pipe, the vehicle must not be moved.
- Check that there is enough suction capacity in the exhaust hose before the nozzle is connected to the exhaust pipe and the engine is started. If not, check the fan impeller rotation direction and/or damper function in the duct system. If necessary check installation of fan start switch.
- Risk of high temperatures! Avoid contact with the nozzle pliers.

IMPORTANT!

If the Exhaust Extraction System is equipped with a balancer for lifting the exhaust hose, it is recommended that the ratchet mechanism on the balancer is engaged when connecting the nozzle.

One-hand control

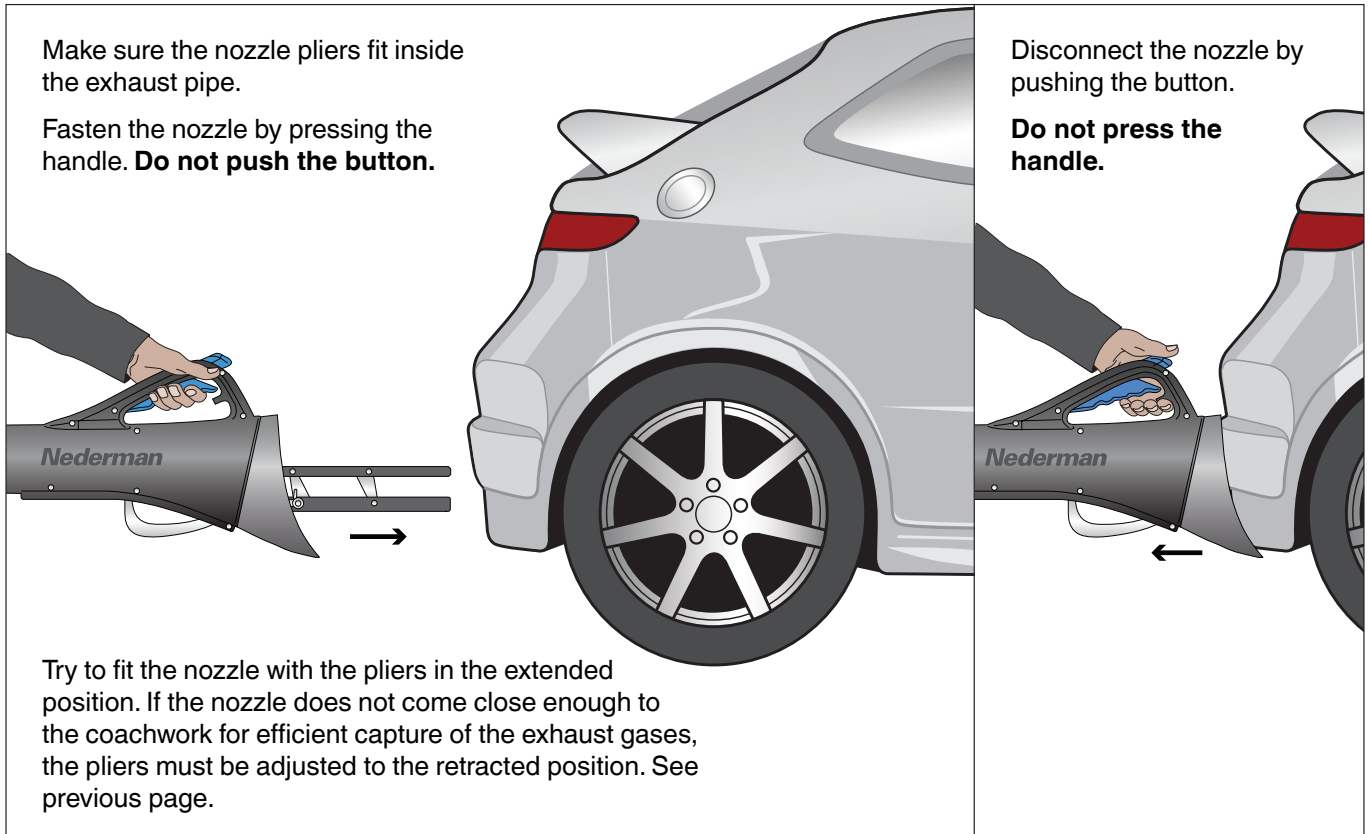

Nederman

www.nederman.com